



Shawnigan Focus

Volume Three - Issue Three

MARCH 2013

A Non-Profit Community Publication

The Shawnigan Gathering

April 6-7, 2013

At the Shawnigan Lake Community Centre

Highlights:

Saturday

Opening: 9:30 am Saturday April 6 by the Honourable Judith Guichon, Lieutenant Governor of BC

- ★ Community Citizen Awards Presentation by the Lieutenant Governor

Followed by Keynote Guest: Songs and Address by Anne Mortifee

Seminars on Saturday and Sunday:

- ★ Shawnigan Watershed
- ★ Village Development
- ★ Local Food Initiatives
- ★ Pros and Cons of Incorporation
- ★ Summer Recreation on the Lake
- ★ Shawnigan Parks and Trails
- ★ the Planned Rejuvenation of the Island Railway



Sunday

- ★ A series of art displays and performances by local youth musicians including a gala musical and dance review on Sunday afternoon.
- ★ A trade show of displays by local civic groups and businesses all day Sunday with a play place for children
- ★ Tiny the Turkey will visit with the Children (Tiny is a 1 year old Tom who thinks he is a dog but is really part boy with attitude)

Food and snacks will be provided by local restaurants both days.

~See full schedule on page 2



Bruce Fraser, Area Director



Jean Crowder, MP



Paul Horn & Ann Mortifee

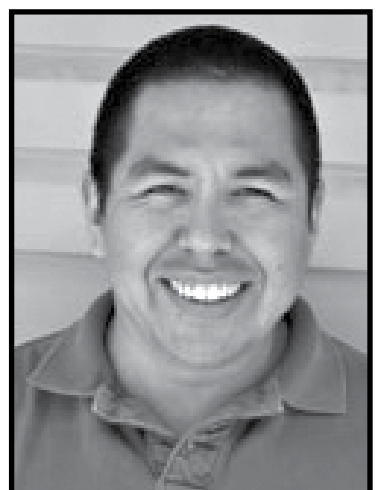

Cheif Michael Harry

Get NOTICED!

Advertise in the

Circulation 3200

Shawnigan Focus!

Advertise for as little as \$24.98/month!!

Contact Kim at ads@shawniganfocus.ca or 250-743-2197

Shawnigan Moments



Photo Credit: Jason Walker

Shawnigan Gathering April 6-7, 2013

Shawnigan Lake Community Centre Program

Saturday

- 8:30 Set up at Shawnigan Lake Community Centre
- 8:45 Welcoming Party Assembles
- 9:30 Lieutenant Governor, Hon. Judith Guichon Arrives to Pipers, First Nations Welcome and Introduction of Special Guests
- 9:45 Lieutenant Governor's Address and Citizen Awards
- 10:15 Reception and Musical Performance by Woodruff Marimbas
- 11:00 Ann Mortifee Performance and Keynote Address
- 12:00 Shawnigan Watershed Issues and Initiatives: Opening by MP Jean Crowder, Lunch available for participants
- 2:30 Nutrition break & arts performances by local youth
- 3:00 Visions of Village Rejuvenation with Architect Christine Lintott
- 4:30 – evening Reception and Art Show at the new "Inspire Shawnigan" Gallery, 1760 Shawnigan-Mill Bay Road in the heart of the Village
- Supper Break: See the Poster at the Community Centre with list of local restaurants
- 6:30 Local Musicians: performances prior to 7:00 session at the Community Centre
- 7:00 Debating the Pros and Cons of Municipal Incorporation for Shawnigan: Sponsored by the Shawnigan Resident's Association

Sunday

- 8:30 Trade Show in the Community Centre Gym: Display tables by local organizations and businesses
- 9:30 Trade Show Opening Includes Children's Play Area and local musicians: Open all day, including snack tables
- 10:00 **Childminding in the Play Area 10:00 – 6**
- Keynote Address: Village, Watershed, Lake and Community – The Challenges of 2013
- 10:45 Nutrition break & arts performances
- 11:00 Simultaneous Sessions: 1. Developing Programs for Youth and Seniors
2. Shawnigan Lake, Parks and Trails – The Future of our Outdoor Recreation
- 12:30 LUNCH tables provided by local restaurants
- 1:30 Simultaneous Sessions: 1. Rebuilding the Island Railway by the Island Corridor Foundation
2. The Future of Local Food and Small Farm Agriculture
- 2:30 Nutrition break & arts performances
- 3:00 Family Oriented Gala Music and Dance Review Featuring Local Performers
- 4:30 Displays take down
- 6:00 Jam Session for Local Musicians: Pizza delivery/order based

SHAWNIGAN FOCUS

March 2013

EDITORIAL TEAM

Lori Treloar
Dave Hutchinson
Brent Beach
editor@shawniganfocus.ca

LAYOUT

Taryn Scott

ADVERTISING

Kim Hennecker
ads@shawniganfocus.ca

FOCUS TEAM

Linda Nelson
Farrell Magnusson
Monica Foster
Sally Davies
Peter Nash
Bev McCooey
Marcy Green

ACCOUNTS

Robyn Greentree
Dewar McCarthy

COPY SUBMISSION DEADLINE

APRIL 2013 Issue: April 5TH

Please send copy as an email attachment using Microsoft Word, text, RTF or Appleworks to: editor@shawniganfocus.ca
Please do not send a PDF as it does not convert properly. Leave hard copies of articles in the Focus box at the The Chipperry: 1-2740 Dundas, Shawnigan Lake

AD SUBMISSION DEADLINE

The 8th of every month for mid-month publication. Ads must be sent in correct sizing, B&W, high resolution, and as a JPEG or PDF. Graphic Designers are available (for an additional fee) to create or reformat your ad. ads@shawniganfocus.ca

CLASSIFIEDS

\$10 (under 30 words) ads@shawniganfocus.ca

ABOUT THE FOCUS

The Shawnigan Focus is an independent, local, non-profit publication, produced by the volunteer Focus team. Shawnigan Focus endeavours to inform; promote harmony and involvement in the community; and interest a broad cross-section of the residents of Shawnigan Lake.

Shawnigan Focus is delivered, free of charge, to postal addresses in Shawnigan Lake (Area B). Out-of-town subscriptions are available. Contact: editor@shawniganfocus.ca

Views expressed in articles are not the opinions of The Shawnigan Focus, but of the authors.

Additional copies are available in The Village.

MAILING ADDRESS

Shawnigan Focus
Box 331, Shawnigan Lake, V0R 2W0



Photo Credit: Sally Davies

Scene on Shawnigan cut-off road. Another reminder of why we must fight S.I.A.'s proposal to dump five million tons of contaminated waste in our watershed....

Watershed protection what are our options?

Brent Beach
Shawnigan Focus

I believe that lake water quality is priority one for most residents of the Shawnigan Lake watershed. Only after we are assured of lake water quality do we go on to the next priority.

We know deep down what we need for good quality lake water – rain moving through natural systems – older forests, healthy streams. Natural systems produce quality water.

The question we all have – How do we ensure that we continue to have those natural systems that produce quality water?

We look around the lake valley. We think about what

has happened over the last 15 years. Almost all the private forest land has been logged. Gravel pits, soil treatment areas, giant fill areas are springing up all over the valley.

This year, more of the public forest land is being logged.

We ask ourselves – How did this happen? Is it something we did? Is it something we didn't do? Could we have prevented it?

At a recent public meeting on changes to the bylaws for the Elkington Lands, the presenter – Doug Makaroff – said something disturbing. I was taping the meeting, so I can write down exactly what he said.

“The preservation of the forest really is not something that the zoning department at the CVRD or the zoning department in any municipality should be monitoring and governing. It is a very detailed forest management plan and that is really rightfully the responsibility of groups like FSC, like Ecotrust Canada, to monitor.”

I had assumed that through zoning our local governments can provide protection for environmental values. Doug is telling us that they cannot – local governments do not have the authority or resources to manage, nor are they in the business of protecting, the

biggest features of our natural environment.

In a later interview, Doug went on to say:

“Forest management and resource extraction are entirely provincially governed. To get to a cutting permit for private forest land does not take any time at all – a weekend. Once you have logged the land, to get a mining permit for gravel can take as little as 6 weeks. With that, they have completely changed the landscape. The local municipality has no jurisdiction over that.”

Jurisdiction over private forest land is completely controlled by the province. This is true whether the land is in a regional district, as in our case, or in a municipality.

Incorporation makes no difference to private forest land practices.

The owner of private forest land, whether a corporation or public pension funds (Timber West has been owned by public pension funds for almost 2 years[1]), will maximize the value of their investment. If they believe that means clearcut logging and then mining, that is what will happen and the local governments have no say.

Can we do anything to change what is happening on the private forest lands in our valley?

Next month – Are Section 219 Conservation Covenants the answer?

Community Alert: SIA draft permit expected soon

Bruce Fraser
Area Director

Several independent sources have indicated that the Ministry of Environment is about to release a “draft permit” for the SIA Contaminated Soil operation at the Stebbings Road Quarry. It is said that the draft permit will be posted soon and that a period will then be allowed for public comment before the final permit is issued. As the Shawnigan Community is clearly on record that no such permit should be issued at all, a draft for discussion

will simply indicate that a permanent one is only a step away and that the public comment is merely window dressing. It is hard to imagine a government decision that would be more unpopular in our community and more disrespectful of our interest in a secure water supply. I believe that the Shawnigan Community must now stand up once again to let government know that issuing such a permit is totally unacceptable.



Local & Organic Produce and Groceries

SPUD.CA Order online and delivered to your door.

SAVE \$25 ON YOUR GROCERIES! Try us today at SPUD.CA
Use promo code **FOCUS25** and receive \$25 off your first order (with a minimum order size of \$50).



G.E.T. Solar Solutions
uniting the sun and earth
creating sustainable energy
GREEN • ENERGY • TECHNOLOGIES

Looking to Make your Home More Energy Efficient?

Jim, local business owner and journeyman plumber of 20 years, specializes in eco-plumbing options and solar hot-water heating systems. His goal is a sustainable energy future.

Consider installing:

- a hot-water tank guaranteed for 25 years
- low-flow water appliances
- a composting toilet
- grey-water collection and redistribution
- radiant in-floor heating
- a solar thermal system designed for you!

Contact Jim Musselwhite at 250-686-0286 or getsolar@shaw.ca
www.getsolarsolutions.ca

“All Candidates Meeting”

Representatives from the Conservative, Green, Liberal & NDP parties will be attending.

Venue: Huge Wilkinson Theatre (Shawnigan Lake School)

Date: Thursday May 9, 2013

Time: 7pm (to be confirmed - it may start earlier)

This is a community wide, everyone-welcome event sponsored by the Shawnigan Residents Association (SRA). Take this opportunity to hear from our candidates, and the party positions on issues that we are so concerned about in Shawnigan Lake.

Dreams at first seem impossible, then seem improbable, and finally, when we commit ourselves, become inevitable
~ Ghandi

Shawnigan Lake South Crown Lands

Dave Hutchinson
Shawnigan Focus

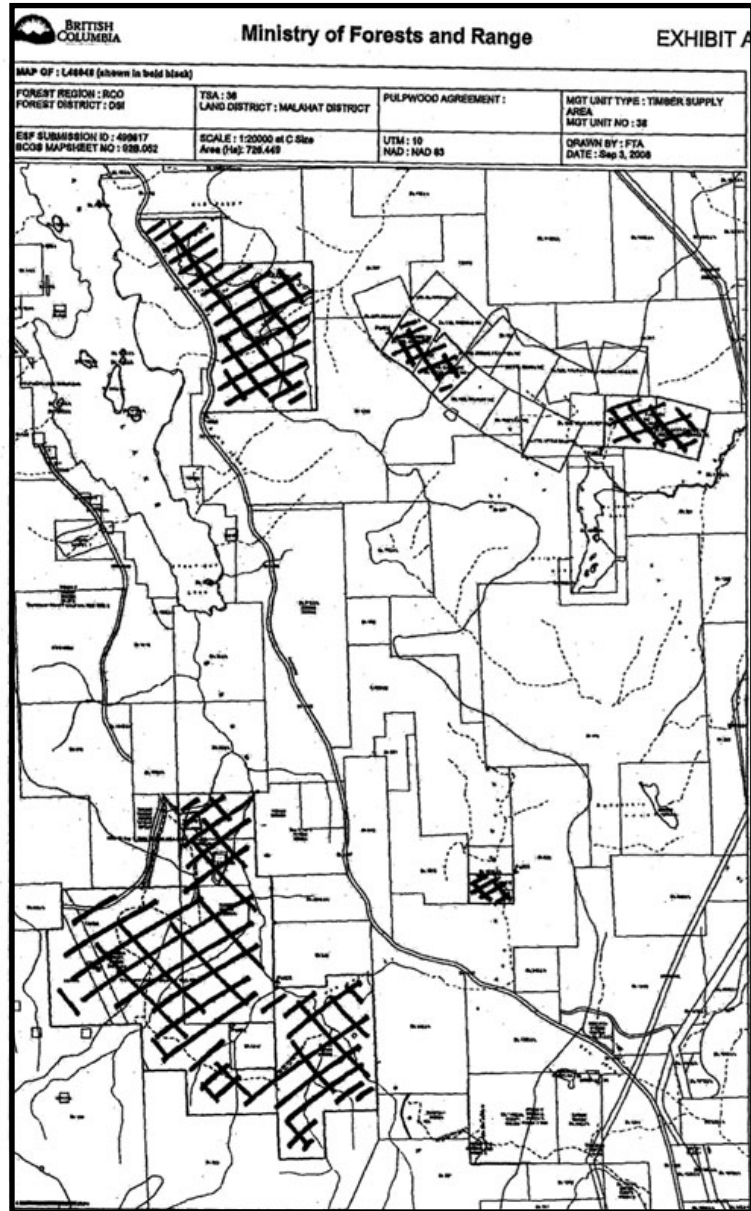

Shawnigan Lake is in the upper left corner of the map

Here is a map that should make your blood run cold.

It is the timber supply map showing the forests that can be cut under a forest tenure agreement between the Province and the Malahat Band.

All the marked areas are Crown land. This represents most of the Crown land in the watershed.

Logging is taking place right now (February 2013) in

the area in the bottom left of the map. It could well be that the entire block will be cut.

We walked this area February 3, 2013. There were a very small number of people involved. Two large machines - one cutting, one stacking - and two or three logging trucks.

Who is doing the Logging?

All the work is being done

by Mike Hamilton Logging from Courtenay, B.C. This article on the company makes it clear that they offer a complete logging operation. From the forest to the ship that takes these logs overseas, Mike and his boys do it all.

The only evidence of the Malahat Band is a trailer at the gate to the property. When a truck leaves, the driver goes to the trailer and appears to get a logging stamp. He stamps the logs and takes the stamp back to the trailer.

Economic Benefits

According to the Malahat Band website, the forest tenure agreement allows them to cut 3,000 cubic metres a year for 5 years, starting in 2008. The areas on this map have not been worked until now. Is it possible then they could take all 15,000 cubic metres this year.

Logs are currently selling for around 65\$/m3 (dollars per cubic metre), with profit usually between \$25 and \$30 /m3. The total economic activity is then \$975000. Over half goes to the logging company and the rest, as little as \$375000, to the Malahat Band. The total economic benefit of this deal to the residents of Shawnigan Lake is \$0.

When you take into account the loss to the watershed

- ★ the loss in the value of the forest in its role of purifying rain water,
- ★ the loss of rain water retention and subsequent increased flooding risk when

forests are clear cut,

- ★ the loss in the value of the area as a destination for tourists (who visits a clear cut?),
- ★ loss in aesthetic value to the residents (whose spirit fills at the sight of a clearcut?)
- ★ the value to the watershed is negative.

Provincial Election

Our problem is a political problem. The Province is using Crown land in the Shawnigan Lake watershed to help it solve a problem arising outside the watershed – the economic issues related to native land claims. There are crown lands outside a watershed used by 8,000 people that could be used instead.

The Province also controls mining in our watershed. Most of the mining is producing gravel used in the Capital Regional District. There are gravel sources outside the Shawnigan Lake watershed. It may cost another \$10 or \$15 a truckload to get to them. Our water quality cannot be traded off for small savings elsewhere.

The Province is considering using a gravel pit in our watershed to solve a problem it has with hazardous and contaminated waste elsewhere on Vancouver Island. MUCH more suitable locations exist that are not in a watershed that is home to 8,000 people.

Our watershed is not the solution to everyone else's problems.

In particular, our watershed is not the solution when it puts our water quality at risk.

A provincial election is coming up. We must impress on all candidates that the Shawnigan Lake watershed is not a garbage pit. That the people of Shawnigan Lake are not going to sacrifice so other people don't have to when many other options are available.

In the upcoming provincial election we have to make it clear to the government that we all care about where we live.

We have to make it clear that we are as mad as hell and we are not going to take it any more.



Welcome Back Malahat First Nation

The Shawnigan Community is honoured to welcome the Malahat First Nation as a formal landowner. It has taken many years of sustained effort as part of the BC Treaty process for the Malahat people to reclaim a portion of their traditional territory, a quest that was signed into being on February 26th at the provincial legislature. Malahat Chief Michael Harry, clearly very proud of the moment, participated in the historic and moving signing ceremony in company with other

Chiefs, Band Councillors, BC Cabinet Ministers, traditional witnesses and attending family members. The agreement conveys one parcel of Shawnigan Basin land immediately and identifies another to be included in a later treaty settlement. Our community now has the great opportunity to forge a new working relationship with the Malahat people.

Appended here is a map showing the lands involved.

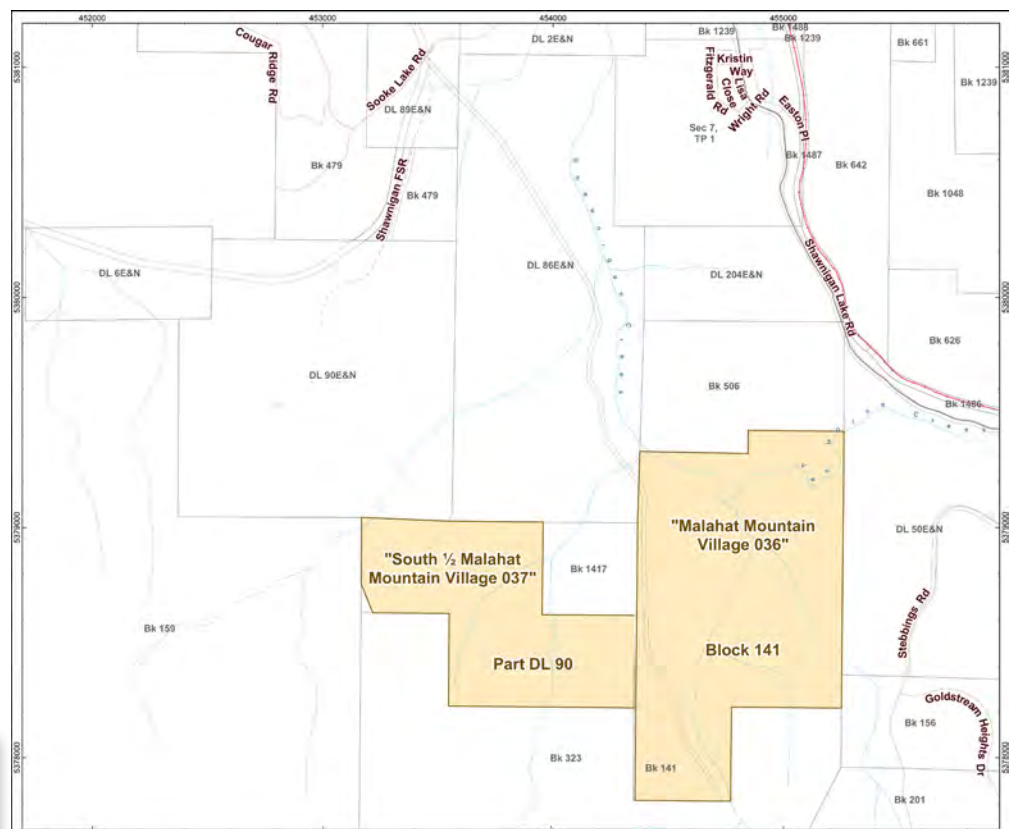

Advertise in the Shawnigan Focus ads@shawniganfocus.ca

The Shawnigan Gathering

What is it all about?

Come and Join Us: The Shawnigan Community is alive with civic initiatives. It is multicultural, artistic, musical, businesslike, celebratory and ecologically innovative. Inspire Arts Collective, Ecovillage, the Museum, the Business Association, the Shawnigan Focus, Resident's Association, the Community Association, the Subaru Triathlon team, the Watershed Roundtable and the Village Development Council are among those civic groups engaging large numbers of volunteers in seeking to enliven our community. We have two internationally recognized private schools, a strong Legion and an active Community Centre.

At its heart, Shawnigan has a First Nations legacy, an historic railway bordering a magnificent lake, the headwaters of the wild Koksilah River, the world class Kinsol wooden trestle and a population eight thousand strong – the most populous unincorporated community in British Columbia. We have a lot of stories to tell each other.

Our first Shawnigan Gather-

ing is designed for us to tell stories, showcase community initiatives and to shape the future. It will give a community platform for all civic groups to display the projects that have drawn willing volunteers to their midst. It will give us a public forum to discuss the stewardship of our lakes and streams, the revitalization of our commercial centre and the pros and cons of incorporation. We can discuss how best to serve our youth, our families and our senior citizens. We can talk about taxes and regulations, the community services to which we should aspire and how best we can work together to create the future that we collectively desire.

The Gathering is being organized to be as inclusive as possible. We are seeking delegates from all parts of the community and all civic groups. With the delegates forming a guaranteed participation, the door will be open to all who wish to attend. There will be speeches, debates, displays, music and food. It will be noisy, engaging, celebratory and fun. Vancouver Island and

Provincial media will be invited to chronicle the event.

The Shawnigan Gathering will be opened by Her Honour, Judith Guichon, Lieutenant Governor of British Columbia. A receiving party of First Nations, pipers, families, children and community leaders will give her an enthusiastic welcome. Her Honour will address the community and will confer civic awards to some of our great community volunteers.

Following the Lieutenant Governor, the Gathering will be entertained and inspired by the internationally renowned singer, song-writer and champion of the environment, Ann Mortifee. Ann is deeply committed to civic responsibility for environmental and social stewardship and is a partner in the Elkington "Living Forest" community in the headwaters of the Shawnigan Watershed. She will enliven our first seminar of the weekend, sponsored by the Shawnigan Watershed Roundtable, engaging us in the creation of a vision for a sustainable fresh

water supply and a process for community led stewardship of the whole Shawnigan Basin. Jean Crowder, our Member of Parliament, will address the roundtable as we begin the examination of what is needed and what must be made possible.

After the opening celebrations, Saturday will be devoted to roundtable discussions of important community issues, including rejuvenation of our village and the pros and cons of incorporation as a municipality. At each break, local musicians will be playing, artists will be displaying their work and local restaurants will be supplying refreshments.

A children's play area will be available to allow parents to engage easily in the seminar discussions. Tiny the Turkey will be in attendance. In the evening the Inspire Arts Collective will be hosting an open house and art show in their new village gallery.

On Sunday, following a keynote address, we will be continuing the series of seminars

on topics that include management of our parks and trails, development of local farm and food initiatives, management of Shawnigan Lake in summer, and the economic potential of a re-established Vancouver Island Railway. Simultaneously, there will be a community trade show with display tables from local businesses and civic organizations that will highlight our rich diversity of business and social enterprises.

Throughout the day, local restaurants will provide samplings both to advertise and to nourish. Young musicians will be playing and in the afternoon, a major musical and dance revue will be staged for the entertainment of children and families.

The Shawnigan Gathering is about celebrating the vitality of our community and about taking local control of the life of our watershed home. It is about making ourselves visible to each other so that we can grow in mutual support as we face the complexity and challenges of our future.



"Tiny" the turkey - Guest at The Shawnigan Gathering

Shawnigan Weather for February 2013 (stats courtesy of UVic Weather Network) ~compiled by Grant Treloar

February Normal	Cigarmaker's Bay		Discovery School		Museum		Elford Road		
	2013	2012	2013	2012	2013	2012	2013	2012	
Average High	7.4	7.3	7.0	7.3	7.2	7.6	7.9	7.6	7.4
Average Low	0.4	2.1	1.0	1.3	0.4	1.9	0.9	1.8	0.7
Extreme High	18.3	10.1	10.5	10.8	11.2	10.3	13.1	11.0	11.0
Extreme Low	-16.7	-1.4	-4.3	-2.6	-5.3	-1.3	-5.1	-2.0	-5.0
Precipitation	155.3	121.3	138.4	81.9	113.1	88.9	123.6	92.8	126.8
Days w precip	16	18	18	18	19	18	19	14	19
Lake Temperature:	Feb 3 rd : 3°	Feb 10 th : 3°	Feb 17 th : 4°	Feb 24 th : 5°					

Shawnigan Gathering 2013 April 6th & 7th

The Shawnigan Gathering is about celebrating the vitality of our community and about taking local control of the life of our watershed home. It is about making ourselves visible to each other so that we can grow in mutual support as we face the complexity and challenges of our future.

**ART
FOOD
MUSIC
FAMILY
DEBATE
COMMUNITY
WATERSHED
RECREATION
TRADESHOW
WORKSHOPS
DEVELOPMENT
INCORPORATION
LAKE MANAGEMENT**

Special Guests:
Lieutenant Governor Judith Guichon
Ann Mortifee
Jean Crowder, MP
Area Director, Bruce Fraser
Christine Lintott
Inspire! Shawnigan Artists
Tiny, the turkey

Child Care Available!
Come join the Shawnigan Lake Community Centre @ The Shawnigan Lake Community Centre

Our future is in our hands...

www.shawniganathering.ca www.facebook.com/ShawniganGathering

For general inquiries: Contact: Georgia Collins 250-208-8904
Local Artists and Performers: Contact: Cheryl Bakke Martin 250-732-6713
To book an exhibitors table: Contact: Melissa Nottingham 250-597-4487
Food Vendors: Contact: Kelly Musselwhite 250-686-0890
To volunteer for this event: Contact: Georgia Collins 250-743-9283



The sign posted by the quarry owner to remind visitors of the need to protect local streams.

Behind the scenes at South Shawnigan Creek

Shawnigan Residents Association and Aqua-Tex

When it comes to managing a watershed and its network of streams and wetlands, the devil is most definitely in the details. A recent example is the 8.4 ha block of land (one of three cutblocks) recently logged by Malahat Forestry Services Inc. in South Shawnigan.

This block of land is immediately adjacent to a gravel quarry that is a favourite playground for off-road vehicles. When it rains, the quarry becomes muddy and that is apparently quite a lot of fun for the 4 x 4 crowd. The problem arises when that muddy water runs off the quarry and into a neighbouring stream that then flows east into South Shawnigan Creek (a coho stream) and then into Shawnigan Lake (the community drinking water supply). What to do?

In March 2012, after spending considerable time tracking the source of sediment and contacting the landowner,

Aqua-Tex was engaged to fix the problem. The result was an inexpensive network of shallow swales and a distribution network of pipes to spread the water over the forest floor and allow the sediment to settle out before it reached the creek. After several frustrating attempts to prevent vandals from damaging the diversion works, the creek ran clear all spring, summer and fall. Then with the onset of winter rains, the muddy water returned.

Upon investigation in January 2013, it was discovered that the muddy water was not really coming from the quarry - it was coming from the cutblock upslope. The water on the cutblock was clear, but the volume was so great that it ran through the quarry, picked up sediment, and overwhelmed the sediment control system. The good news was that logging equipment was still on site and could be mobilized to fix the problem.

After learning who the professional foresters were

that were responsible for the site (Capacity Forest Management), designing a plan, and clearing it with the foresters, Aqua-Tex worked with staff from Mike Hamilton Logging to fix the problem before the equipment left the site and created extra cost and delay. MHL donated their equipment time to build a bioswale across the site that would divert the clean water back into the creek before it even reached the quarry. Aqua-Tex donated their time to design and oversee the work, and a potentially large problem was solved in a timely way. The water in the creek is now clear once again. This is but one example of simple, proactive measures that must be used to solve problems in the field, site-by-site. We would like to thank Capacity Forest Management, Mike Hamilton Logging and the quarry owner for their willingness to go the extra step and support the community in its efforts to protect the streams of the Shawnigan Watershed.



Water running off the new cutblock and across the gravel quarry, picking up sediment as it travels.



Group Fitness | Personal Training | Weight Loss Supplement Centre | Infrared Sauna | Tanning Strength & Cardio Equipment | Free Weights

Valleyview Centre
#1-1400 Cowichan Bay Rd, Cobble Hill
Email: info@valleyhealthandfitness.ca
Web: www.valleyhealthandfitness.ca
Phone: 250-743-0511

Biggest Loser BOOTCAMP
jazzercise



TECHNICAL SERVICES INC

Cowichan Valley Phone Number: 250-929-5333
Visit us in Valleyview Centre
17 - 1400 Cowichan Bay Road, Cobble Hill, BC

*Need help with your technology challenges?
That's what we do.*

- Onsite service and drop off at our store in Valleyview Centre
- New and used computers, parts, and peripherals
- Help with and repair of smart phones and tablets
- Parts and service for home entertainment and security systems
- Tutoring, workshops, or classes
- Website design, hosting, and domain registrations
- Books, promotional materials, and logos brought to press-ready

← [Globe] [Phone] [Laptop] [Tablet] [Printer] →

Onsite solutions for home and business

Lexington Spa

GRAND OPENING SPECIAL

2 for 1

Manicures | Pedicures | Foot Reflexology

Share the pampering with a friend, your mom or maybe your daughter . . . everyone deserves to be fussed over! Its your turn.

Enjoy all this in our new South Shawnigan Studio.

Licensed • Insured • Bonded

CINDY BEAM
Certified Reflexologist (RAC)
& Nail Professional
Home visits available.

by appointment only :
250-514-1380
www.lexingtonspa.ca
lexingtonspa@shaw.ca

PROUD SUPPORTER OF

Canada Water Week, March 18-24



WATERWEEK
HEALTHY RIVERS, LIVING LAKES

In recognition of Canada Water Week, March 18-24, the Shawnigan Residents Association will be hosting an event to remove the old dock lodged in the north creek between the lake and the weir on Saturday March 23. See www.shawniganresidentsassociation.com for more details.

Participate in EARTH HOUR

Saturday, March 23rd at 8:30 p.m.

Turn off your lights for an hour

<http://earth-hour.org>

Bicycling - A great new way to enjoy the Shawnigan Lake Adventure

Michael Schindler
Cowichan Family Caregivers Support Society

Experience the Cowichan Valley as you have never seen it before!

As geocaching is now part of the Shawnigan Lake Adventure, so is bicycling.

There will be two options to choose from - a 22k and a 77k ride; both, mostly on the scenic TransCanada Trail (TCT). Drink in the beauty of the land varying from pastoral farms, beaver ponds, long stretches of lush rainforest and the historic Kinsol Trestle.

The 22k Family Ride: You will be bused from the Shawnigan Lake Community Centre (SLCC) to the starting point at Glenora Park. For about 16k, the ride takes you on smooth gravel along the TCT passing the Kinsol Trestle to Renfrew Road and heading towards the SLCC. For families who wish to finish before the last 6K on the slopes of Renfrew Road we offer a shuttle back to the SLCC.

The 77k Ride: You also will be bused to the starting point in downtown Duncan. The first 4k on roads will lead to the trailhead at Sher-

man Road. From there your ride takes you on packed gravel to Lake Cowichan. Continue along the TCT to see Skutz Falls Provincial Park, Marie Trestle and finally the Kinsol Trestle. The last 6k on Renfrew Rd will take you back to the SLCC. Rest stops with fresh fruits and energy bars in Lake Cowichan and Glenora Park will invite you to take a break for a few minutes.

Ride for charity and enjoy a fun and adventurous day on Sunday, June 2nd.

For more information visit www.shawniganlakeadventure.com



Hinterland calling

Joseph Gollner
Shawnigan Resident

Focus readers who live in the Shawnigan Lake Village or around the lake may be surprised that a significant number of Area B [Shawnigan Lake] residents live, in some cases, a good distance from the lake. I choose to call these distant parts of Area B, the Hinterland. Area B is a huge land mass. Its population is the largest of any Regional Area in the province; in fact our population is larger than the majority of municipalities in BC. Moreover, thanks to Canada Post one can reside in Area B and have any of these postal addresses, Shawnigan Lake, Cobble Hill, or Duncan.

The Focus naturally concentrates on the activities of its readers in the village and around the lake where most live. Feeling that those of us that live in the Hinterland were being neglected in

terms of coverage, I asked the Editors if a column could be put in the paper from and about residents that live in the Hinterland. They agreed and this is the first column. It is not my intention to write monthly. Instead, others that live in the Hinterland, e.g. someone who lives away down South in Area B, might write an article about the endless stream of trucks speeding by their homes. Or perhaps someone that lives by the Renfrew Rd. that pays taxes for non-existent services will choose to write a column. Besides the challenges of living in the Hinterland, there are also many benefits of doing so and these benefits need recognition by future writers too.

Throughout Area B differences exist depending where individuals choose to live but there are also common issues. One such issue is our road network's sad physical

condition - condition that is compounded by the lack of safety and information signage, but abounds with faded or non-existent centre lines and curb markers, together with a profusion of pot-holes and crumbling pavement. One wonders about what happens to the provincial income and gas taxes we pay given our road conditions. Our road maintenance is a provincial government responsibility. The coming provincial election will provide us many opportunities to questions all candidates about our roads.

If you live in or near the Hinterland, please think about writing a column under this title in future issues of the Focus. Write a column about issues that are of concern to you and your neighbourhood or equally the benefits your neighbourhood enjoys from being in the Hinterland.

Koksilah Farmers Institute

Angela Auchincloss
Koksilah Farmers Institute

The Koksilah Farmers Institute - 'Living the Rural Arts' - is a new organization that came about through the wants and needs of a Community. Our mandate is to Preserve, Protect, Practice, Promote the Rural Arts. It has been a year in the making and now the first baby steps are about to be walked.

Whether you farm, care about sustainable agriculture or support purchasing local food

for your family and community, come out to a meeting. Learn and share...we can all garner information from each other, we just need to listen and not be afraid to ask questions.

Meetings will be the 3rd Wednesday of the month at 7pm at the Cowichan Station Hub. Our first meeting is March 20th and great things will follow from there!!! Come out to a meeting and find out about memberships

Koksilah Farmers Institute.... come and meet your Community!

www.shawniganfocus.ca - follow us on twitter

**SHAWNIGAN MILL BAY
AUTO PARTS (1992) LTD.
743-3355**

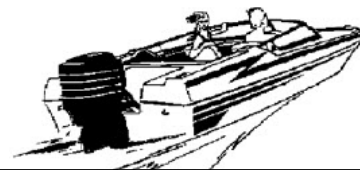

**Mill Bay's
Auto/Marine
Parts Store
Pioneer Square**

**Blue's Bins
&
Hauling Ltd.**

Duncan
(250) 701-7305
Victoria
(250) 888-4834

- Mini Bin Rental - 12 and 15 yard
- Dump Box Service
- Top soil, sand, gravel, bark mulch delivery
- Flat Deck Service
- Small Equipment Hauling
- Fifth Wheel Hauling
- Snow Plowing

**EUTHBERT
CONSTRUCTION**
GENERAL CONTRACTORS

**Custom Homes By Quality Builder
In Shawnigan Lake**



*Custom Homes, Custom Docks, Pilings, Concrete Piers,
Excavations, Foundations, Drainage, Retaining Walls,
Concrete Countertops, Patios, Sidewalks, Etc.*

ANY Project or ANY Problem With Your Home - Give Us A Call!

250-743-9000

Thank you to our Advertisers! We really appreciate your support.

Letters to the Editor

CVRD budget bloated by excessive pay at the top:

Pay for top staff doubles in four years

As the Cowichan Valley Regional District prepares to approve a tax increase of 8% or more, with inflation under 1%, beleaguered taxpayers are left wondering, "How did this happen?" The first step to answering that question is to look at where the funds are being spent – and this involves looking deeper than the usual budget information released by the CVRD.

The single largest item in the CVRD budget is staff salaries. Remarkably, information on salaries is not available in the raft of budget information provided by the CVRD, which focuses instead on categories such as "General Government", "Planning" and "Community Parks".

Fortunately for transparency and accountability, the CVRD is required by law to produce a Public Bodies Report each year, which gives detailed information on staff salaries and expenses, among other things. This public document is available on the CVRD website.

The bulk of CVRD staff are unionized and have received wage increases of about 2.5% in recent years. This is better than many people in the community, especially considering the benefits and job security, but perhaps not embarrassingly out of line. However the biggest growth in salaries by far has been at the top end, the group of 34-plus CVRD "exempt staff" who are paid between \$75,000 and \$178,000. (Figures are from 2011, the most recent available.)

The Public Bodies Report

shows the amount paid to the group earning over \$75,000 has grown dramatically, from \$1.6 million in 2007 to \$3.4 million in 2011, a whopping 211% increase. This is the elephant in the room. The number of people in this top group doubled between 2007 and 2011, and they all received generous pay increases. By comparison, the amount paid to CVRD staff earning under \$75,000 grew only 13% for the same period.

When I asked the CVRD about this, a human resources manager wrote me that "for the past few years the increases for exempt employees have been identical to those received by all other employee groups". That would mean increases of about 2.5% a year, or slightly over 10% over a four year period. However, the Public Bodies Report tells a different story, showing that actual increases for the top group were much higher.

Below are a few examples of increases between 2007 and 2011, in no particular order:

- ★ General Manager, Corporate Services, \$147,290, up 19%
- ★ General Manager, Planning and Development, \$137,941, up 27.6%
- ★ General Manager, Parks, Rec and Culture, \$130,562, up 32.8%
- ★ General Manager, Engineering Services, \$132,952, up 30.3%
- ★ Manager, Parks and Trails, \$101,700, up 33.9%
- ★ Manager, Finance, \$102,872, up 26.7%
- ★ Manager, Community and Regional Planning, \$113,361, up 32%
- ★ Manager, Water Management, \$106,200, up 24.6%
- ★ Corporate Secretary, \$105,419, up 21.4%
- ★ Administrator, \$178,615 (2007 unavailable)

The Public Bodies Report details similar increases for most of the 34 "exempt staff" of the CVRD. And this doesn't include the extras: travel expenses, employee benefits, and good pensions, which increase in cost as salaries rise.

Apparently, pay increases of "2.5% a year" aren't quite the whole story for the top staff. The CVRD tries to explain this, citing "merit increases" and "expanded responsibilities" and the like, but this is simply not a credible explanation for such large increases to so many

top staff. Another culprit is the perceived need to keep up with, or even "leapfrog" salaries in other districts. This combination of factors leads relentlessly to the same result - when the 2012 figures are released in May, there is little doubt that those at the top will, once again, have benefited handsomely.

Our elected CVRD directors have the power to stop the excessive wages from continuing to grow. The directors have approved these increases, year after year. Ironically, directors themselves are modestly paid, earning about \$23,000 a year. Whether the directors knew what they were doing when they approved staff salaries, or simply didn't bother to look beyond the smoke screen provided by CVRD management, is an open question.

This year could be different, however. The 2013 budget is set to be approved at the March 13 CVRD board meeting. Shawnigan area Director Bruce Fraser has said he will propose a cap or "redline" on future salary increases for top earners. Let's hope that the majority of his fellow directors read the public mood correctly, and support his motion. The ever-expanding expense at the top must be halted before it reaches truly crippling levels, as it has in Victoria and elsewhere.

Source: Public Bodies Reports, available on the CVRD website.

(Go to "Services" then "Corporate Services" then "Finance")

2011: www.cvrld.bc.ca/DocumentView.aspx?DID=1643

2007: www.cvrld.bc.ca/DocumentView.aspx?DID=366

Blaise Salmon

Re: Blackmore letter in the February issue

I'm responding to Mr. Blackmore's letter in your last edition which, despite his positions, I appreciate that he took the time to write. Here is some perspective on his comments.

Regarding the CVRD property on Cameron Taggart Rd., his statement that the property was never farmed is at odds with the William family's history. They have been on that land and farmed it for generations. Land that is zoned Agriculture 1 with half of it in the Agricultural Land Reserve.

The Supreme Court of British Columbia ruled in favour of the residents, of this

community, that challenged the legality of the CVRD's plan to place an eco depot where the zoning did not permit. Had Mr. Blackmore read the judgment he would understand that the CVRD is not above the law. The Court also clearly identified that the community was supportive of recycling but not of the inappropriately chosen CVRD eco depot location.

In November 2011, the CVRD posed a referendum question to the public on whether the eco depot location on Cameron Taggart Road was acceptable. The voters of Area B [Shawnigan Lake] decisively defeated that referendum with a 75% No vote.

Contrary to Mr. Blackmore's opinion, the CT Group is not focused on the past. To the contrary we are working on behalf of our community. For example, since May, working in cooperation with the CVRD, we have been campaigning against the proposal to dump five million tonnes of contaminated soil into the Shawnigan Lake drinking watershed. This serious threat to the lake might impact on your drinking water Mr. Blackmore. I know what the CT Group has done to try to protect the lake - what are you doing Mr. Blackmore to help protect Shawnigan Lake from industrial contamination?

Joseph Gollner, Citizen Together Group

Stop, look and listen!

As young children we learn to recognize signs before we can even read or spell and for many, one of the first signs they know is the "STOP" sign...the shape of the sign, the bright red colour and the letters S T O P spelled out in bold print... so please tell me when as adults they seem to not be able to read or understand what a stop sign means...we live on Catalina Drive along with the nine other neighbours' homes who have to drive up Worthington Road to access Renfrew...we have lost count of the number of times we have had to hit our brakes because people do not STOP at McKean and Worthington Roads!!!! Many of these cars are carrying young children who have recently been picked up at Discovery School...please take the 3 seconds it takes to come to a complete stop, take a look to the left and make sure you are safe to make the right turn on to Worthington.

Thank you so verly much,
Pam and Malcolm Verley

Mason's Store
Family owned since 1956
Your one-stop convenience store.
We have everything:
Subs & Hot-Dogs - Slush - Instore Bakery - Lottery
Giftware - Greeting Cards - Balloons - Fax & Photocopy
Dry Cleaning - Rug Doctor - Hunting Licenses - Fishing Tackle
1855 Renfrew Road
Ph: 250-743-2144 Fax: 250-743-7883

Service and Repair
lawn mowers, lawn tractors, outboards,
trimmers, chainsaws, and other power equipment!
Pick-up and delivery available
Sager's Small Engine & Marine
250-743-3771
1666 Jersey Road, Shawnigan Lake
sagersmarine@shaw.ca



Art House

Ongoing classes & workshops ...
Register online or call 250-743-5846.
THE PLACE TO MOVE. THE PLACE TO BE MOVED.
West African Dance, Drum, Yoga, Modern & more ...
Casual, family-friendly atmosphere. Sliding scale tuition.
1756 Wilmot Avenue at Dundas Street.
www.MoonDanceArts.ca
Creativity. Community. Celebration.

The CVRD

Dear Sir:

The CVRD runs a facade of a budget process each year before it socks it to local taxpayers with more than \$50 million in spending and tax increases up to 11% for this year. Looking closely at 10 years of taxing and spending shows how they really prepare their budgets:

First - never consider the state of the economy or taxpayer's interests when spending plans are prepared. Our local economy is weak and continues to struggle after 5 years of recession and unemployment. There is high consumer debt, depressed housing prices and inflation less than 1% but that is simply ignored by the CVRD.

Second - provide no leadership in controlling spending like other governments have done. Give staff and directors access to rich travel and expense accounts of more than \$350,000 per year. That's over \$1000 per day in the CVRD for meals, conferences, travel, entertainment and fancy hotels!

Third - Directors help themselves to a raise in their own pay and expenses (up 117% in 10 years). Give all 220 staff a generous raise regardless of performance or taxpayers' ability to pay (salaries and wages up 79% in 10 years - 20 CVRD staff now haul in more than \$100,000 in pay per year).

Automatically increase the pension costs and benefits for CVRD employees (up 135% in 10 years).

Fourth - Increase spending way in excess of inflation - In the past ten years inflation was less than 22% but spending increased over 100%!

Fifth - Hire more staff and introduce new programs for special interests. CVRD recovers less than 1/3 of what it spends from the small number of actual users of rinks, community centres or its theatre. These are some of the largest expenditures in the CVRD next to employee pay.

Claim the budget process is too complicated for most people to understand and so just increase spending year after year.

Approve grants in aid to almost everyone who shows up with a good story to support causes that are mostly outside of the CVRD's mandate. More than \$4 million has been given away over the past 5 years to many groups with little accountability.

Have staff present phony analyses about how cheap CVRD taxes are compared to buying a Tim Horton's coffee every day or owning a cell phone as if a mandatory tax is comparable to a consumer choice.

Blame everyone and everything else for CVRD tax increases and completely ignore high CVRD wages and benefits as a factor in increasing taxes every year. Over 1/3 of spending is on employee pay.

Is it any surprise that the CVRD board has doubled taxes in the past decade by a whopping five times the rate of inflation? Has your income doubled since 2001?

W.E. (Bill) Dumont

Re: Reg Blackmore's comments on the Eco Depot

The whole point of the issue was that the CVRD did not have the authority to build a transfer station on the property it purchased. A delegation to the Board on August 11, 2010 informed them of this. In December 2012, a legal judgment coming out of the law suit, filed by a citizen, confirmed the CVRD did not have the authority.

Hopefully, Mr. Blackmore would agree that no government should be allowed to run roughshod over its by-laws. It is disgraceful that citizens had to reach into their own pockets and sue their local government.

The eco depot became a money pit because the CVRD failed to abide by its own by-laws.

We can move forward; however, the CVRD board and the CVRD Administration have the immense challenge of re-establishing trust. We, being fully aware that the best predictor of future action is past action, wait... and watch.

Lavonne Huneck, Area B

Family Day - a new tradition in Shawnigan

It was in early December that I realized that the new holiday in BC, Family Day, needed to be celebrated to keep it from becoming "just another day off". It would take some organization and creativity. We already had the theme - Families. We already had the perfect location - Shawnigan. And, I knew just the perfect group to organize it - Lori from Shawnigan Museum, Marian from the Style Centre and Community Association, Christine from

WE ENCOURAGE YOU TO SEND US LETTERS...

The Focus will publish your thoughts on Shawnigan issues: bouquets you would like to offer to special people; things that strike you as funny; challenges you want our civic leaders to consider; and/or ideas that would better our community. Letters to the Editor must be accompanied by the author's full name, address and phone number, but the contact information, other than the name, will not be published. Letters should be limited to 300 words and we reserve the right to edit for brevity or to refuse inappropriate or abusive language. Letters should attack issues - not individuals. Send letters to editor@shawniganfocus.ca



Family Day train art

Dwight School, and me from the Village Chipperry. Our enthusiasm touched AJ and Vincy from IluvAJs, who had recently successfully organized the 2nd Annual South Cowichan Toy Run. They quickly became part of our ad hoc group.

During meetings, we collectively came up with the idea of a Passport to Shawnigan which would involve the community, family, and history. After many meetings, and fine-tuning, Family Day was ready to be celebrated - Shawnigan style. Families registered for their passport and set out to discover part of the train history of the area. After amazing photos were presented for various tasks

completed, the passport was stamped. Each task completed was eligible for a ticket in a prize draw. Winners received \$hawnigan Dollar\$ which are redeemable at participating local businesses.

On Family Day, Dwight School hosted a great day of activities - a hot dog with all-the-trimmings lunch was served to the participants before they became artists in residence, creating plaques that will be displayed on the fence below the Museum. This public art display will be installed March 23rd at 9:30 - a true community project that can be shared by all was created.

How did we judge the suc-

cess of the first ever Family Day in Shawnigan? By the smiles on everyone's faces as they headed home to continue their Family Day celebrating, and by the smiles of our group as we began planning Family Day 2014.

Thanks to the many who helped along the way: Glen Jones; the vet; Bruce Fraser for arranging the CVRD grant-in-aid; students and staff at Dwight; the Shawnigan Lake Community Association; fellow Family Day organizers; anyone that I missed and all of the wonderful families who played together on our first annual Family Day event.

Patty Oldfield, Village Chipperry

Family Day follow-up

Thank you for your participation in the first Annual Shawnigan Family Day celebration. Join us March 23rd at 9:30 a.m. to install the Family Day train art pieces on the fence below the museum.

There were a number of unclaimed prize tickets from the event. If you still have

your tickets, check the numbers below to see if you are a winner:

178 196	178 240
178 208	178 252
178 209	178 256
178 212	178 267
178 213	178 270

Winners can pick up their prizes - Shawnigan Dollars - at the Village Chippery.

Any ticket that has not been claimed by March 23rd, will be re-drawn from our registration lists. Winners will be notified through the contact information provided on passport registrations.

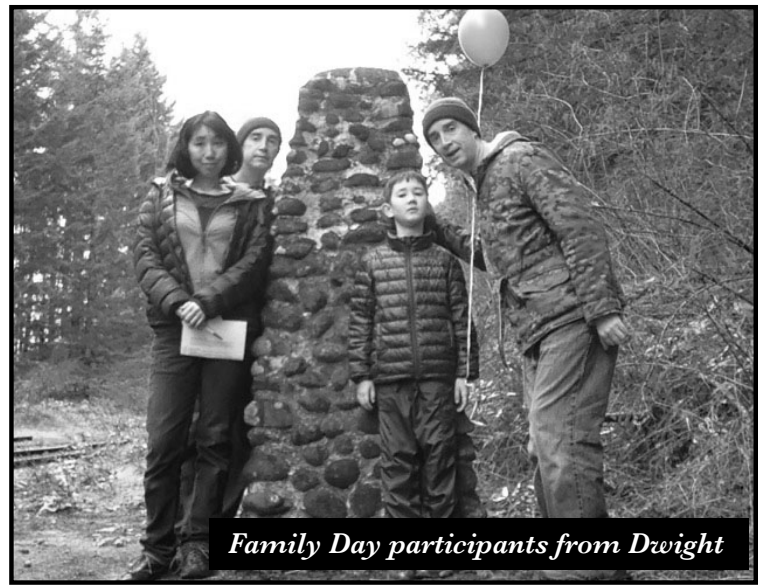

Family Day participants from Dwight

TAX RETURNS

E-File Services, Fast Returns, Prompt Service

T1 Personal Income Tax and Corporate Taxes
Small Business Accounting, Computer Consulting,
Simply Accounting Consultant

Phone for an appointment - Your office or mine

250-743-9868 or Cell 250-920-8677

10% Discount with this Ad • 15% Seniors Discount

Pickup & delivery available

A & R TAX SERVICES

Alice Baal, proprietor • Email: abaal@telus.net

INSPIRE! Member profile

Jennie Stevens
Inspire!

Creativity expressed through passion and purpose is a wonderful thing to experience,

and nothing is more fulfilling than blending the many things one loves into a daily practice.

For many years Shawnigan alchemist Karen Dyck has been doing just that.

From the epiphany one morning 13 years ago inspired by the aroma of the cottonwood buds, to the desire to “participate in a meaningful and supportive relationship with the earth and its people”, Karen’s business Vitale Natural Care grew out of a love of plants & people, and the deep connection they share. “The human relationship with plants is vast and profound; they offer nourishment, medicine, beauty and a sensual emotional connection. The art of perfume - composing music with natural aromas - is the poetic connection with nature I cherish above all.” Karen’s craft gives her an opportunity to connect on an intimate level with her clients as she weaves her magic, creating individually handmade perfumes using exotic resins, essential oils and essences from all around the world.

In addition she loves to explore with her many unique and delicious smelling combi-

nations of ingredients in the Vitale creams, massage oils and lip balms. These ingredients, all taken from sustainable natural sources, help to keep us in touch with the various gifts of the seasons,

as Karen incorporates the essence of many local plants in the scents she creates.

Karen’s passion is to provide a natural alternative to the stock synthetic products on the market, and offer a product that will nurture and feed the body with things that it recognizes.

Working in partnership with Gifty Serbeh Dunn, Karen uses Shea butter from Ghana for many of her products, and she prides herself on having a company that is based on building relationships with women who are all in the business of supporting one another. She is a woman with a huge heart, and a deep caring attitude towards those in need. Parts of

Karen’s journey in life thus far have made her receptive to the value of creating supportive connections. From an early age, music and singing were integral in Karen’s life, at first shared with family, and later becoming a solace during trying times. Making music provided “a world where beauty longing and dreaming came together. My voice was my way to join with the pulse of life...” She

refers to much of her childhood as the “gypsy years”, with her family moving over a dozen times during which her family’s adventures taught her how to “be an island”, while she navigated her way through making new connections with peers, and then having to say goodbye on a regular basis. By the age of 16, Karen’s parents had settled in Shawnigan Lake, but by then she was ready to make her own choices of adventuring and it wasn’t until after 10 years of prairie living, during which time she earned a Bachelor degree in Education and discovered a passionate love for theatre, that she returned to put down roots in the village of Shawnigan. While raising 3 children in the close-knit community which has remained her home for over 20 years, Karen has also been involved in teaching, writing, directing and acting with the local theatre group, as well as studying aromatherapy and herbal medicine. “I am drawn to the beauty in life, the aromas of nature... my gifts are expressions of love... I weave my days together like a tapestry - work, community, family and adventures - every day is new and different.” contact Karen through vitalenaturalcareinc 250 886 5511. Excerpts from “The Passionate Life- Creativity, Connection and Community” by Lesley Fountain



RBC Royal Bank®

Get instant results with our Rate Loss Program.

Switch to an RBC Homeline Plan® credit line and pay only prime + ½% vs. prime +1% at your bank.

Join the thousands who have lost rate and saved thousands of dollars.

Introducing the RBC Rate Loss Program: a fast and easy way to go from paying 4% (prime + 1%) at your bank to 3.5% (prime + ½%) by switching to an RBC Homeline Plan® credit line. You could save as much as \$5,000 in interest payments* and worry less, sleep more and feel better. And we'll even cover your switching costs*. So get with the program - and lose the rate you've been carrying today.



Contact me today to find out more:
Emily Black
Mortgage Specialist
250-715-7692
emily.black@rbc.com

Advice you can bank on™

* We will pay the basic title insurance fee (not including migration fee), appraisal/property valuation fee and one discharge/switch out fee at another financial institution (up to \$300 maximum). Offer excludes mortgage preparation charges that you may have to pay. Minimum advance \$50,000. * Savings based on \$100,000 secured line of credit with interest being paid over 10 years comparing a 3.5% annual interest rate to a 4.0% annual interest rate. The interest rate will fluctuate with the Prime rate and is subject to change at any time without notice. Rate is effective as of September 20, 2011. Personal lending products and residential mortgages are provided by Royal Bank of Canada and are subject to its standard lending criteria. © / ™ Trademark(s) of Royal Bank of Canada. RBC and Royal Bank are registered trademarks of Royal Bank of Canada. 39106 (09/2011)



Be sold on expertise.

I am your link to
VICTORIA BUYERS



FARRELL MAGNUSSON

Call Farrell for your
FREE NO OBLIGATION Home Evaluation

1750 Shawnigan-Mill Bay Road
250.743.7151
250.477.7291
Shawnigan

farrell@farrellmagnusson.com

www.farrellmagnusson.com

Open 6 Days per Week ~ Monday - Friday 9:30-5:00 ~ Saturday 9:30-5:00

NEW LISTING : Cobble Hill Hobby Farm Potential

Move in ready. Tidy and well maintained small acreage with large pond and 3bed/2bath rancher. Level and sunny with lots of parking. New roof, newer septic, new paint, updated flooring, landscaping, cement and rock work, and covered back deck. Detached outbuilding could be workshop, office, studio, or extra accommodation.

\$389,500



Shawnigan Watershed Roundtable

Georgia Collins

Shawnigan Watershed Roundtable

“Sometimes the answer is in our hands and we don’t even know it”

Shawnigan Lake is a precious resource that contains our life source, water. The total usable freshwater supply for ecosystems and humans on this earth is less than 1% of all freshwater resources.

The world’s 6.9 billion people are currently appropriating 54% of all the accessible freshwater contained in rivers, lakes

and underground aquifers.

Every second, the urban population grows by 2 people.

As our community grows, what are we going to do with our portion of the total usable freshwater supply?

Let’s talk about it at the Shawnigan Gathering. This is an opportunity to further the discussion on ecological stewardship of our watershed.

We will be joined by Lieutenant Governor, Judith

Guichon, Ann Mortifee, Jean Crowder, MP and Malahat First Nations to kick off what is sure to demonstrate that:

“Our future is in our hands!”

SHAWNIGAN GATHERING 2013

www.shawniganathering.ca
www.facebook.com/ShawniganGathering

Sources: <http://waterlife.nfb.ca/> <http://www.unwater.org/watercooperation2013.html>

Shawnigan Lake Triathlon

Sarah Malerby, Race Director
Shawnigan Lake Triathlon

On May 26, 2013, the community of Shawnigan Lake will host the Subaru Western Triathlon Series 7th Annual Shawnigan Lake Triathlon.

An exciting new event in the triathlon this year is the addition of the Western Canadian High School Championships. High School students will compete in the Sprint, Super-Sprint or Relay divisions. Financial scholarships will be awarded to the top Grade 12 male and female and there will be two World Championship 2014 qualifying spots for the top male and female in the 16 -19 year old division.

Also new this year is the addition of an Athlete Pledge Program to fundraise for the South Cowichan Rotary Club. 100% of all funds raised will be used for local trail building projects. Great prizes will be awarded for the top fundraisers and those who raise a minimum of \$250 will receive a unique and limited edition art print of the Kinsol Trestle, designed by local graphic artist Justin Nakatsuka, owner of Row West Clothing. More information and pledge forms are posted on the triathlon website.

Shawnigan provides a beau-

tiful race course that starts and finishes at West Shawnigan Provincial Park and is a great triathlon for beginners.

If you like to swim, bike or run, you might consider training and participating in one of the following courses:

Super-sprint: 500m Swim, 10 km Bike, 4 km Run (12-19 year olds only)

Sprint: 500 m Swim, 22 Km Bike, 5 km Run

Olympic: 1500 m Swim, 44 km Bike, 10 km Run

Half-Iron: 1900 m Swim, 88 km Bike, 21 km Run

Relay: Recruit a friend or two and make a team!

Triathlon weekend – May 25 & 26, 2013 – will include many community events such as the Shawnigan Village Triathlon Festival, Free Kids Run, Entertainment, Marketplace, Camp Pringle Fundraiser Dinner, Race Expo and Triathlon Spectating. Mark your calendars and watch for more information coming soon.

Volunteers are needed on race weekend to help with the many tasks that are required at a triathlon event – such as

site set-up, course marshals, water station attendants, registration, etc. If you are interested in joining this amazing and fun team of volunteers, please register by visiting the Subaru Western Tri Series volunteer form at <http://triserics.ca/volunteering.php>.

More information and detail on the Triathlon can be found on the website: http://triserics.ca/shawnigan_lake/index.php or email Sarah Malerby, Race Director with your questions at s.malerby@triserics.ca



Sarah Malerby on the Kinsol Trestle

ads@shawniganfocus.ca



Shawnigan Lake
Acupuncture

Sara Tillie, R.Ac
250-743-7767

Lois Saunders

250-743-5559

Esthetics by Lois
Shawnigan Village

1755 Shawnigan-Mill Bay Road
Box 413, Shawnigan Lake, BC V0R 2W0

Volunteering at the Triathlon

Janey Woolls, 10
Shawnigan Lake

Last year, I experienced volunteering at the Shawnigan Lake triathlon and I will never forget it. I was a volunteer at the food station where we made lunch bags for the volunteers and served the athletes after their race.

The morning of the triathlon, I woke up an early start. When we arrived at the race site, I was put to work right away. We wrapped sandwiches and put apples in the lunch bags. Then we had to prepare the station where the triathletes come to eat after their events. We cut and cov-

ered bagels with peanut butter for over an hour! (It was so tempting to eat them! Eventually after all my work, I was allowed to eat one.)

My favorite part about volunteering was watching the events while I worked. It was exciting to watch the triathletes come out of the water after swimming and peel off wetsuits and jump on their bikes. (Of course, they wore biking gear underneath.)

I am definitely volunteering again this year! You should too – it was fun!

Clean ~ Refreshing ~ Delicious

WATER

**Right next to the Village
Chippery in the Purple
Building - 2740 DUNDAS**

1 Gallon - \$1.00 ★ **5 Gallons - \$2.50**

AVAILABLE 24/7

FAST ~ CONVENIENT ~ LOCAL

The Wild Side

Dave Hutchinson
Shawnigan Focus

Red Squirrels – Cute and feisty but getting scarce on the South Island

I have many fond memories of these energetic little creatures but most recollections are from decades ago. These cheeky, delightful tree dwellers were a common sight in our yards and forests until the late 1980s when their numbers started to noticeably decline. It is rare now to be loudly scolded for daring to venture into their territory. At least that's the case around southern Vancouver Island where they have been largely displaced by the Eastern Gray Squirrel – those brawny alien invaders whose aggressive assertiveness makes them nowhere near so endearing.

The Red Squirrel (*Tamiasciurus hudsonicus*) is the most widely distributed squirrel in Canada. It is not considered

to be endangered.

Often confused with their close cousin, the Douglas Squirrel (*Tamiasciurus douglasii*), whose colouring is different. The Red Squirrel is just that, rusty-red in colour with white underparts, whereas the Douglas Squirrel is reddish-brown with yellow underparts. Douglas Squirrels do not reside on Vancouver Island but both species are found together on Cortez Island.

A high juvenile mortality reduces their average lifespan to about 5 years with the oldest known Red Squirrel in the wild reaching 10 years of age.

Their average weight is about 200 grams (0.44 pounds).

They mate in early spring from March to May and then again in August to early September. A second breed-

ing period tends to occur in warmer areas of their range. A typical litter of four is born after about 35 days.

They are well known for their ability to communicate by calls which consist of rattles, screeches, growls, buzzes and chirps and are often used in defense of territory or in response to threats from predators.

In late summer through autumn, they harvest cones and store them in middens which are a central hoard that is easy to defend from competitors. Middens vary in size and number depending on habitat, food availability, and individual squirrel. They contain enough food to last one to two seasons and are often used by several generations of squirrels.

Red Squirrels eat a wide range of foods that include



North American Red Squirrel - Photo by Sandra Stewart

fruit, seeds, nuts, bark, fungi, buds, and insects. They will occasionally eat bird's eggs, young birds and even mice. Their preferred food is conifer seeds.

Most red squirrel nests are constructed within 30 metres of cone caches. Red squirrels prefer natural cavities, but will also construct nests in branches or underground hollows.

The invasive Gray Squirrel (*Sciurus carolinensis*), is not native to BC. In 1914, eight squirrels imported from New York were released in Stanley Park, and by 1920, the species was fully established in Vancouver. The widespread Gray Squirrel population on Vancouver Island originated from one male and two females that escaped in 1966 from a game farm in Metchosin.



Take a Hike!

Robin Massey
Shawnigan Focus

Near the end of February, The Iron Butts set out once again to the Koksilah River Ancient Forest trail near Kapoor Hill which is about 15ish kilometres from Shawnigan Village.

If you haven't been there for a while (or ever!) be AWARE that recent windstorms have really taken their toll and have created some interesting

obstacles across the path! We employed our yoga skills as we ducked under trees and stretched over the limbs of the fallen alder trees. After about 6 or 7 sections of nature's jungle gym we arrived at the Old Growth Grove on the bank of the river.

I love the story of how, in the 80's, two loggers came upon this area and felt an amazing energy from the old and wise Douglas firs and decided to drop their chainsaws in refusal to end the grove's existence. The forest company then deemed it a reserve and terminated more plans for logging.

There are still some murmurs lingering of logging these ancient splendours, by the property owner, and you can see that a few of the trees are marked. Let's hope this never happens and we can enjoy this amazing space for

many years to come. The Ancient Forest Hiking Guide does a fabulous job of giving directions to this area (link at the bottom).

As for the fallen trees of late? I'm hoping that due to it being a popular dirt biking, quadding and recreational location that just maybe one of them will visit wielding a tool of sorts to help clear the way! Normally this is a gentle traipse through the forest but right now...well, perhaps Mother Nature is protecting this area in her own way.

Next month: Miner Road to Quarry Peak view

Source: <http://www.ancient-forestguide.com/big-trees.php?ID=3>, cited February 24, 2013.

Robin frolics in Cowichan Valley's viewpoints with The Iron Butts Hikers (www.theontree.com)

Personal Tax Season is here,
... and we are ready for it.

Wise Financial Services Inc

OFFERING A COMPLETE RANGE OF FINANCIAL SERVICES

As in past years we have our team in place to make sure we give you the great service you deserve. In fact, we are confident that during March and April we can process your taxes within 2 working days or we will process them for FREE!

GO TO OUR NEW WEB SITE

www.wisefinancialservices.ca

TO ACCESS YOUR

" PERSONAL TAX ORGANIZER "

Don't have a computer? Call or drop by our office and we will make sure you get a copy of the Organizer. Got a question about taxes, come and see us we'll be happy to help. Go to our web site for Video Tax Tips.

* E-filing with direct deposit means
a refund can be deposited in 10 days or less!

* Drop-ins are welcome - no appointment is necessary.

WISE FINANCIAL SERVICES Inc.

Shawnigan Village
1757 Shawnigan-Mill Bay Road

250-743-5999

www.wisefinancialservices.ca

(for your convenience pay by Cash, Debit or Credit cards)

Extended Hours of Operation during Tax Season

In effect - March 1st to April 30th

9am to 7pm Monday through Friday plus Saturdays 10am to 4pm.

We appreciate your referrals!

Receive a Gift Certificate to the Village Chippery for your referral.



K-9
BriteBark
BRITISH COLUMBIA



NATURAL, ANESTHETIC-FREE, TEETH CLEANING FOR PETS

By appointment, two convenient locations :

DUNCAN #1F - 2753 Charlotte Road
250-597-2275

VICTORIA #102 - 300 Gorge Road West
250-592-2323

www.k9britebark.com - k9britebark@yahoo.ca



Village Development Committee

Kelly Musselwhite
Area B Alternate Director

For over a year, a committed group of local citizens have dedicated their time preparing ideas involving Village Core Development, which will be presented to the greater public at the Shawnigan Gathering on Saturday, April 6 at 3:00 pm. Leading the “pencil” during this thoughtful task of transforming space to place is architect Christine Lintott (recommended by MacDonald and Lawrence Timber Framing re-

sponsible for rehabilitating the Kinsol Trestle). Christine has not only donated a considerable amount of her weekend time, but also much of her professional expertise to this project.

Specific considerations of developing a master plan, whereby individual projects can be accomplished under the umbrella of a magnificent and meaningful whole, include:

- ★ discussions of our arts,

culture, and heritage and the reintegration of these themes into our modern setting

- ★ the creation of a centralized hub - the opportunity to cultivate a feeling of arrival at an intended destination

- ★ the integration of the Island Corridor, which speaks to our past

- ★ the opportunity to make

visual contact with the lake prior to Mason’s Beach when driving north

- ★ the construction of interconnected paths as well thought out walking spaces supporting pedestrian access, not only along the water’s edge perhaps from Old Mill Park to Mason’s Beach, but throughout the village core

- ★ and, to design a specific

means in which we can move and gather as a community whether this space be formalized public markets, festivals, or events central to who we are.

Our goal? To put life on the streets of Shawnigan Lake, to attract tourists, to increase economic development potential, build a Village worthy of our pride, and to revive the magic of this place more than 8000 resident’s call home.

What’s in a name? Halhed Road

Lori Treloar
Shawnigan Museum

You will not find Halhed Road on a current Shawnigan Lake map but it was one of the first roads named in the area. Halhed Road, after the Halhed family who arrived at Shawnigan in 1892, was for some reason renamed West Arm Road (probably when the road was extended) and then eventually, Renfrew Road. The original road headed west from the Old Victoria Road (now Shawnigan Lake Road) near the outlet of the lake and led as far as the Halhed property.

Richard Beauchamp Halhed, like many of his contemporaries, came to Canada seeking a lifestyle that was less restrictive than life in England. In those days, most wives had very little say in major decisions, so Mrs. Halhed was left to pack up the household, including the three children and a maid, and then follow her husband to Vancouver Island. Halhed travelled ahead of the family to find a house and be settled before they arrived. When Mrs. Halhed found out that she was pregnant, her trip

was made sooner than later. Although she was told that the family would live in Victoria she was shocked to find that, instead, her husband had bought property in the middle of nowhere – Shawnigan Lake. As the new house wasn’t ready when she arrived, they rented in Victoria until it was finished. Her fourth child was born there.

Mrs. Halhed, an intelligent woman and a brilliant pianist, was used to a busy social life in England. Therefore, she was devastated to find that her new home was on a rocky point across the lake from the train station and it could only be reached by boat. There were no roads, no neighbours and no shops. For Mr. Halhed it was the ideal place to live for the hunting and fishing. The Halheds’ had frequent guests, but these were mainly men who came to hunt and fish. It would have been a lonely life for Mrs. Halhed.

The children were brought up as properly, as was possible, for English children in the BC wilderness. There was a nanny, and the children took their meals in the nursery. In the evenings, the

family dressed and gathered for music and books. Richard even insisted on the great British tradition that the children go to the seaside every summer. To that end, the family packed up and moved to Mill Bay where they camped on what is now the Brentwood School property.

The Halhed house, known as “The Hall”, is believed to be the first house built at Shawnigan Lake on the lakefront and it survived late into the 20th century. When the Halheds left Shawnigan Lake around 1900 they sold their house to the King family. The King family lovingly kept “The Hall”, for the most part, preserved the way the Halheds left it. Today, the old house is gone, the huge property has been subdivided and Halhed Road no longer exists.

shawniganlakemuseum@shaw.ca

April 23rd at 7pm - Join us at the museum for a fun night of “Show and Tell”

Bring an interesting object or artifact and tell us all about it...Refreshments will be served.



Hazel King and Brownie Gibson at “The Hall” Circa 1965



250-743-1103

RALPH RYAN
Shawnigan Lake

... with over
25 years
experience in
Lawn Care

cutabovelawncares961@msn.com

EUTHBERT
CONSTRUCTION
GENERAL CONTRACTORS

**Custom Homes By Quality Builder
In Shawnigan Lake**

*Custom Homes, Custom Docks, Pilings, Concrete Piers,
Excavations, Foundations, Drainage, Retaining Walls,
Concrete Countertops, Patios, Sidewalks, Etc.*

ANY Project or ANY Problem With Your Home - Give Us A Call!

250-743-9000

In search of Steelhead...

Richard Wilby
Forged Fly Fishing

Anyone torn from their sleep at 5am by an obnoxious alarm clock would wonder what on earth could justify such an arduous event. Seconds later, the realization pulls you hard like the prey you're after: Steelhead.

One cold January morning, my fishing partner and I stumble into a coffee shop on the way to Cowichan River. Upon entering the establishment, in our waders and boots, a group of locals inquire if we were going to "try our luck today". Both of us, with grins on our faces, nod, to which the group erupt in laughter.

They must have seen the puzzlement on our faces. The group was in disbelief. "Why on earth would anyone want to stand (bleep) deep in freezing water all day?"

My partner and I exchanged a quick look and a smirk, got our coffee and left without a word. Poor guys... they've never experienced the weight of steel.

Fly fisherman understand the therapeutic release of casting with a single handed rod, however, casting with a two hander, makes you feel like a Herculean artist.

When we reached my favour-

rite stretch of the Cowichan River, with I my 8lb, 13.6 foot, two-handed fly, we were greeted by the locals. They had already been up and down the river twice with two steelhead photo-trophies to prove it. I was surprised to hear both were caught in no more than 8 inches of water! Good news! Wading (bleep) deep would prove unnecessary today.

After two hours of being in the frigid waters, the only action we had encountered was snagging our gear on the bottom of the river. Over the course of the day, other fisherman passed us with updates of the river's successes, tips and favourite spots in the pool where we were casting. When we finally stopped for lunch, I was very thankful for my small kerosene burner. Hot food never tasted so good next to the icy river.

Near the end of the day, we headed back to our starting point of the river to try our luck again in an attempt not to go home empty handed. (don't worry, empty handed as in no pictures)

A fella that had been in the water since before we'd arrived, greeted us in passing, and made his way to the very



Richard Wilby with his prize

top of the run. In no time, his float went down and his rod tip went up: the fight was on.

All of us could tell it was a good size beast early on into the fight, and we saw that he was having trouble controlling it. Even though it wasn't our tight line, we felt the excitement and watched as the show unfolded. After a lengthy battle, he triumphantly displayed his catch: an estimated 16lb buck steelhead. Similar to Paparazzi we called

for him to pose, and like a veteran celebrity, he obliged.

Newly invigorated, I tied on a perfect imitation of what just caught Nussy, and fired it out about 50 meters down river from the still beaming angler. Witnesses are a wonderful thing, because on the first cast, I got my first fish of the day. Not as impressive, weight-wise mind you, but to me it was the catch of a lifetime: an estimated 8 pound doe. In keeping

with tradition, pictures were taken and smiles were given. No other fish were caught that day.

When I think about the anglers who have been steel-heading all their life and are still drawn back to the river every season in that endless pursuit of chrome, I feel blessed. I have the rest of my life to look forward to this... standing (bleep) deep in freezing water all day, trying my luck.

May I have a Word?

Monica Foster
Shawnigan Focus

Some time ago I noticed the phrase "anytime soon" being used more and more by journalists in the last sentence of their report. It has become as

ubiquitous at the end of these pieces as "Once upon a time" is at the start of a fairy-tale. It's used with any subject: "Despite the changes to the coaching staff, don't expect the Piranhas to win anytime soon." "Even though the Premier expressed concerns over the process, it's not going to change anytime soon." "Even though February was mild, don't expect the cold temperatures to end anytime soon."

Reporting should be objective and this catchphrase leaves one, not with the facts, but with someone's point of view - usually negative. It assumes the reader or listener is in agreement with the reporter. Many people may not be fans of the Piranhas; may support the current process; and enjoy the cold weather. It also supposes that we are all in agreement with the definition of "soon". Is it later today? Next election?

Next century? So even though I think this phrase is overused and inappropriate, don't expect reporters to stop using it anytime soon.

I apologize for leaving you hanging with last month's game. I assumed everyone would have a dictionary with them at all times (oh wait, that's just me). You may have been reading the Focus in a waiting room or a coffee hop, and cursing me for not providing the answers. Here again are the words and their definitions.

Ethereal: airy, light, delicate, heavenly. Jejune: intellectually unsatisfying. Lachrymose: given to weeping; tearful. Lobsouse: a sailor's dish of stewed meat, vegetables, and ship's biscuits. Lugger: small ship with four-cornered sails. Prink: smartly dress up. Prolix: lengthy, tedious. Veleta: ballroom dance in triple time. Virago: fierce, abusivewoman.

dewarmccarthy.com

Dewar McCarthy & Company
Accountants

1.250.483.4739

Accounting Taxation Guidance

April Specials

PULLED PORK on a PRETZEL BUN \$10
Oven roasted Barbeque Pulled Pork . . .
on a Pretzel Bun topped with Homemade Coleslaw.
Proudly served with our Hand-Chipped Fries

TERIYAKI HALIBUT RICE BOWL \$10.50
Halibut Nuggets . . .
grilled with bell peppers, onions and teriyaki sauce - served over rice.
Topped with shredded carrot, diced green onion and pineapple.

CURRIED CRISPY CHICKEN \$12
Our lightly battered Deep Fried Chicken Breast Strips . . .
topped with curry gravy and served over rice.
Includes a scoop of our deliciously healthy Homemade Coleslaw.

OPEN DAILY
DINE-IN OR TAKE-AWAY
LUNCH • DINNER • LICENSED
250-929-8886
2740 Dundas Road - Shawnigan Village
'the purple building . . . where friends meet'
Still time to enjoy **MARCH SPECIALS** - view menu and specials at www.villagechippery.com

Accepting your Shawnigan Dollars

Offering a menu as diverse as our customers.

Village Chippery.com

Shawnigan (Area B) Parks Commission

Margaret Symon
Parks Commission Chair

The Shawnigan Parks and Trails Master Plan (2010) contains a number of recommendations, among which is an assessment of alien invasive species in our parklands. Did you say “spies in our parks?” No – much worse! Alien invasive species are plants and animals that are not part of native ecosystems, but which have escaped into our natural environment, where they displace native species and cause other harm. Invasive alien species are known to cause negative impacts to human health and safety, to the economy, and to the environment.

In 2012 the CVRD contracted the Coastal Invasive Species Committee (CISC) to conduct an invasive plant inventory of all Electoral Area B Community Parks (there are 47) in Shawnigan Lake, as well as West Shawnigan and Memory Island Provincial Parks. The purpose of the study was to create an inventory to support the development and implementation of management and long term monitoring strategies for invasive plant species at Electoral Area B Community parks. Action levels were assigned to the plants using the CSIC priority invasive plant list: 1 ‘Eradicate’ species, 6 ‘Contain’ species, and 4 ‘Control’ species were identified.

The study found 33 of the 47



parks surveyed contain 11 of the 48 priority invasive plants identified in the CISC management area. Fourteen parks are free of priority invasive plants.

Eleven different species of invasive plants were found. Three species, including giant knotweed, yellow iris, and Canada thistle, are BC Regulated weeds, meaning land managers are required to manage them under the Provincial Weed Control Act. Four plant species – daphne/spurge laurel, English holly, English ivy, and yellow iris – exhibit some level of toxicity to humans. The most dominant invasive plant species found in Shawnigan Lake Community Parks is Scotch broom, followed by Scotch thistle, and Himalayan blackberry.

Of particular concern is the fact that Scotch thistle, which exists in isolated patches within the CISC management region, is a robust intruder in our area. A total of 14 hectares have been inventoried in the whole

CISC region for the presence of Scotch thistle, of which 7 hectares alone exists within Stebbings Road Community Forest. Stebbings Road Community Forest was the largest park inventoried (156.7 ha), and contains the largest stands of invasive plants in Electoral Area B Community Parks, with approximately 60 ha of Scotch broom and Scotch thistle. Contaminated soils imported from the CRD to sites along Stebbings Road may have contributed to the spread of Scotch thistle and other aliens.

On all sites, with the exception of one park where a localized pocket of giant knotweed was found, manual/mechanical treatment is possible. (Chemical treatment, using stem-injection of herbicides, is the recommended treatment for giant knotweed.) Careful planning is certainly necessary to make the best use of available resources to eradicate, contain, or control alien invasive plant species at Shawnigan Lake.

SHAWNIGAN BEACH ESTATES GREENBELT



On behalf of the Cowichan Valley Regional District and the Shawnigan Lake Parks Commission, the CVRD Parks & Trails Division would like to remind you and your family about the Shawnigan Beach Estates Greenbelt in your neighborhood.

Shawnigan Beach Estates Greenbelt

The purpose of this greenbelt area in your backyard is to preserve the vegetation and natural systems for the protection and enhancement of the natural environment within your neighborhood. These undisturbed greenbelts provide important habitat for a number of birds and small animal species. Greenbelts provide wildlife corridors that connect with larger habitat areas enabling small animals to travel as their life cycles require. Designated trails are located in these areas to minimize erosion and damage in other parts of the area.

Disturbance and Encroachment into the Greenbelt

We would like to remind you that any encroachment on the Greenbelt, destruction of vegetation (including tree modification or removal), dumping of any waste (including yard clippings), and building of tree forts within the Greenbelt is strictly prohibited under the Cowichan Valley Regional District’s *Park Bylaw No. 738*. We appreciate your cooperation in refraining from dumping any fill, garbage, garden waste, or compost materials in the Greenbelt as it may contain invasive plant species.

Invasive Plants

Examples of invasive plant species of concern include English Ivy, Garden Loosestrife, Purple Loosestrife, Himalayan Blackberry, Scotch Broom, Knapweed, Giant Hogweed and Canada Thistle. E-Flora BC provides more information on invasive species, as well as a list compiled by the provincial government.

<http://www.geog.ubc.ca/biodiversity/eflora/invasives.html>

Tree Hazards

If you have any concerns about a potential tree hazard in the Greenbelt area, please contact the CVRD Parks & Trails Division at the number below. We appreciate your efforts to respect and value your local parks and greenbelts.

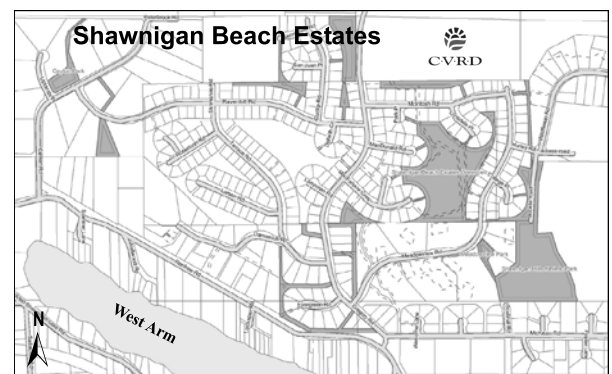

Contact Information

Ryan Dias, Parks Operations Superintendent
CVRD Parks & Trails Division
175 Ingram Street, Duncan BC, V9L 1N8
250-746-2620 fax: 250-746-2621
parks@cvrld.bc.ca



www.shawniganfocus.ca - follow us on twitter

WHAT IS IT? WHERE IS IT? WHY IS IT?



CONGRATULATIONS

The winner for February winner was Roswynne Cuthbert

The photo showed part of a hinge on one of the impressive gates at Shawnigan Cemetery. The striking pair of gates was a generous donation by Gavin McArthur in honor and memory of his parents Rob and Pat.

Winners receive two specialty coffees at Shawnigan House (formerly Moziro)

First correct answer sent to editor@shawniganfocus.ca wins

CORRECTION RE: FEBRUARY MOVIE REVIEW
Zero Dark Thirty
The Star rating should have been 4 1/2 out of 5



eaglearts academy

where inspiration finds direction...

summer arts camp

July 14 - 28
grades K - 12
residential or day

DANCE
DRAMA
MUSIC
PIANO
VOICE
VISUAL ART
DIGITAL FILM
ANIMATION

We offer exciting and challenging arts programs for motivated young people who want to develop and refine artistic skills and explore their creative potential.

Join us for non-stop fun and learning through the Arts.

www.eaglearts.ca



info@eaglearts.ca (250)896-4664

a summer program of the Dwight International School

SHAWNIGAN FOCUS

CLASSIFIEDS

WANTED

Vintage dealer/collector wants to purchase your clothing, jewelry, purses, footwear, luggage, etc. Call 250-929-4213 or email spazzycat@shaw.ca

WHAT IS MISSING IN SHAWNIGAN?

1. A Deli meat counter, also serving smoke meat sandwiches homemade soups etc.
2. A gift and fashion jewelry shop.
3. Pet supply store.

If you believe there is a need for something I have not mentioned feel free to add it to my list. Please respond in order of preference to: Guinivere555@msn.com

Like The Focus on Facebook!

PAINTING BY HART

Certified • Custom Residential • Commercial
Family owned & operated since 1948
Call us today for your free estimate

Call: 250-733-2220
www.PaintingByHart.com

PROFESSIONAL • EXPERIENCED • RELIABLE

COMMUNITY CALENDAR

- ★ **Area B Director's meetings**
1st Monday of each month – 7 pm at SL Community Centre (SLCC)
- ★ **Shawnigan Advisory Planning Commission**
1st Thursday of each month. 7 pm at SLCC
- ★ **Shawnigan Parks and Recreation Commission**
Feb 28th - 6:30pm at SLCC. Usually the 3rd Thursday
- ★ **Shawnigan Improvement District**
2nd Monday of each month 7 pm at #1 Fire Hall
- ★ **Shawnigan Residents Association Board meeting**
3rd Tuesday of each month 7pm - www.shawniganresidentsassociation.com
- ★ **Shawnigan Lake Business Association**
1st Tuesday of each month 7 pm, currently at the Village Chippery
- ★ **Shawnigan Lake Community Association**
4th Monday of each month 7pm. Contact bburr@shaw.ca to get on the mailing list. Anyone interested in joining is welcome.
- ★ **Shawnigan Village Development Council**
As announced. Everyone welcome!
- ★ **Shawnigan Watershed Roundtable**
Everyone welcome! (see website for details: www.shawniganwatershedroundtable.ca)
- ★ **Inspire! Arts, Culture and Heritage** has MOVED...come and visit our new Community Gathering Space across the street from Oma's bakery and Shawnigan House Coffee. Join us for our Grand Opening ART SHOW, "TOGETHER", SATURDAY April 6th starting at 4:30 p.m. Submissions in all genres are still being accepted for the Grand Opening. Join us in celebration of what we can do TOGETHER. Info at: www.inspireshawnigan.com
- ★ **Shawnigan Lake Facebook** group has the objective to be for daily postings of people's stories, news and events on a more personal scale. Please view <https://www.facebook.com/groups/129586433786330/>
- ★ **Malahat Legion:** 1625 Shawnigan-Mill Bay Road - For more info: 250-743-4621
- ★ **Local Talent:** Home-based business directory. Meets 3rd Wed. of month at Inspire!
- ★ **Shawnigan Lake Museum** - Hours: Friday, Saturday, Sunday 11:30-4. www.shawniganlakemuseum@shaw.ca

SHAWNIGAN LAKE VOLUNTEER

FIRE DEPARTMENT

PO Box 201, Shawnigan Lake, BC V0R 2W0
Telephone: (250)743-2096
Fax: (250)743-2096
Non-emergency Telephone: (250)812-8030
Email: shawniganfire@shaw.ca

Department Members Attended 17 Calls in February

Department Officers attended 2 burning complaints.

Callouts for February:

- ★ Friday, Feb 1 - 1st Responder off Shawnigan-Mill Bay Rd
- ★ Sunday, Feb 3 - 1st Responder off W Shawnigan Lake Rd
- ★ Thursday, Feb 7 - 1st Responder in the Village
- ★ Friday, Feb 8 - 1st Responder in the Beach Estates
- ★ Sunday, Feb 10 - Alarms Activated on Renfrew Rd
- ★ Tuesday, Feb 12 - Alarms Activated on Renfrew Rd
- ★ Wednesday, Feb 13 - 1st Responder on Shawnigan Lake Rd
- ★ Wednesday Feb 13 - MVI on W Shawnigan Lake Rd
- ★ Thursday, Feb 14 - 1st Responder on Shawnigan Lake Rd
- ★ Friday, Feb 15 - Possible Structure Fire in the Beach Estates
- ★ Tuesday, Feb 19 - 1st Responder off Renfrew Rd
- ★ Wednesday, Feb 20 - Chimney Fire in Burnum Park
- ★ Monday, Feb 25 - 1st Responder on Shawnigan Lake Rd
- ★ Monday, Feb 25 - Tree Through House off Renfrew Rd
- ★ Wednesday, Feb 27 - 1st Responder on Silver Mind Rd
- ★ Thursday, Feb 28 - Chimney Fire off W Shawnigan Lake Rd

Shawnigan Lake
AUTOMOTIVE & MARINE
250-743-2122
QUALITY "OLD TIME" SERVICE

- BCAA Certified Auto Repair Facility.
- Certified Government Inspection Facility & Out of Province Inspections.
- Certified Mechanics At The Best Rate.
- Alignment Specialists.
- Tire Sales & Repair.
- Diagnostics for Domestic, Import & All Make Marine Services & Repairs.

Thank You to our Loyal Customers for giving us the highest satisfaction rating with BCAA

Full Service Save-On-Gas Station
Loaner Vehicles and Door-to-Door Service when available.
Call now and make appointment today!

250-743-2122 Located at the 4-way in Shawnigan Lake Village.

steeples
Bar & Grill

Lunch - 11:30am
Brunch - 10:30 Sundays
Dinner - 5:00pm Daily

250.743.1887
www.steepleresaurant.ca

2744 E. Shawnigan Lake Rd.

Check out our website:
shawniganfocus.ca